



Zero Reveal Flush Lid Riser X1211 Installation Instructions

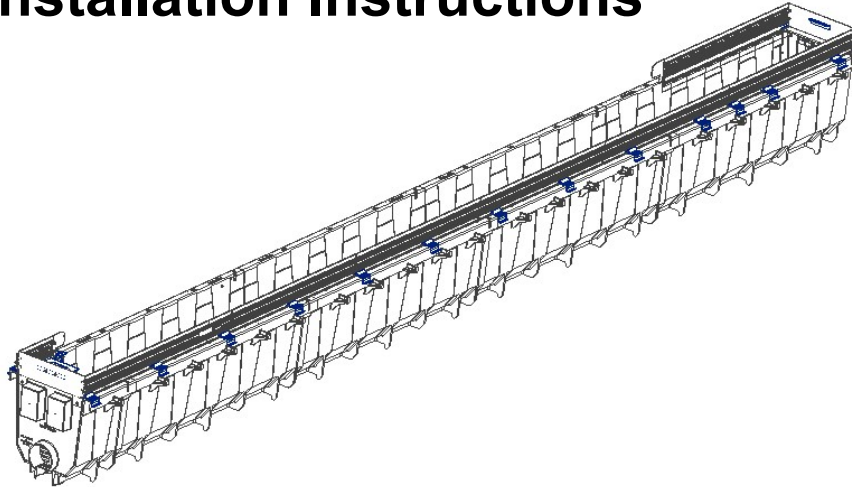

Table of Contents

Safety Information

Important safety instructions	1
Installation notes	2

Parts Description

Parts list and diagrams.....	2
Required Tool List	2

Operation

Installation Procedures.....	3-5
Installation Diagrams.....	3-5

 WARNING! IMPORTANT SAFETY INSTRUCTIONS:

- READ AND FOLLOW ALL INSTRUCTIONS
- Installation shall only be performed by a competent trained automatic pool cover technician. Improper installation could lead to bodily harm and pre-mature failure of the components.
- Proper protective equipment should always be worn for installation.
- Follow all tool manufacture safety guidelines and use safe tool practices.
- These instructions are specific to the flush lid riser installation, all other installation instructions should be followed.
- File away any exposed sharp edges. Failure to do so could lead to injury.
- Install lid end caps to protect consumer.
- All conductive components must be bonded per national and local codes. Failure to do so could lead to electrical shock.

Parts Description

1	2	3	4	5	6
7	8	9	10	12	13

Parts List

1. M3997 — Housing Raiser Zero Reveal End Cap - QTY: 2
2. M2221 — M2220 Housing Cap End Plate Support for Zero Reveal Flush Lid
3. X1211 — Flush Lid Riser Zero Reveal - QTY: 1
4. X1212 — Riser Panel, zero reveal 4ft for water side - QTY: 1
5. A2409 — Lid kit only flush, zero reveal for 14in box - QTY: 5
6. X0008 — 6in Flush Lid Panel - QTY: 1
7. X0009 — 7.5in Flush Lid Panel - QTY: 1
8. H0176 — 10-32 Nylock Nut - QTY: 4
9. H0152 — Screw PPMS 10-32 x .5in - QTY: 4
10. A1721— 60pk #12 Tek Screw Kit QTY: 2
11. A2489 (or A3303) — Quick Attach Mechanism Mounting Kit (Not Shown) QTY: 1
12. M8096 & M8097— Flush Lid End Cap Protectors QTY: 1 Set
13. M3994 — Riser panel fixed height hook 2in long QTY: 20
14. M3917—Riser Leveling Bottom Clip for X1211

Tools Required

- 10" Chop saw with carbide blade for cutting aluminum
- Cordless Drill with 5/16 hex bit, #2 Philips bit
- 3/8" Wrench
- Square
- Tape measure
- File
- Marker
- 7/16 Wrench

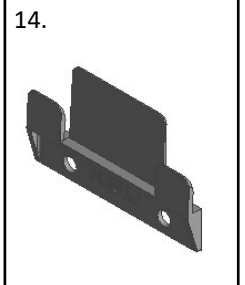

Zero Reveal Flush Deck Aluminum Lid Kit

Includes all the parts necessary to install the lid system for all Latham Auto Cover Systems up to 20' TS. Additional parts available for longer lengths. Parts may vary slightly by type of kit ordered.

Tools Required

- A3987—Backfill Turnbuckle Brace

Installation Procedures

Note: This is showing attaching to new molded housing M3995. For straight wall housing applications such as concrete housings please see pg. 6 for additional steps.

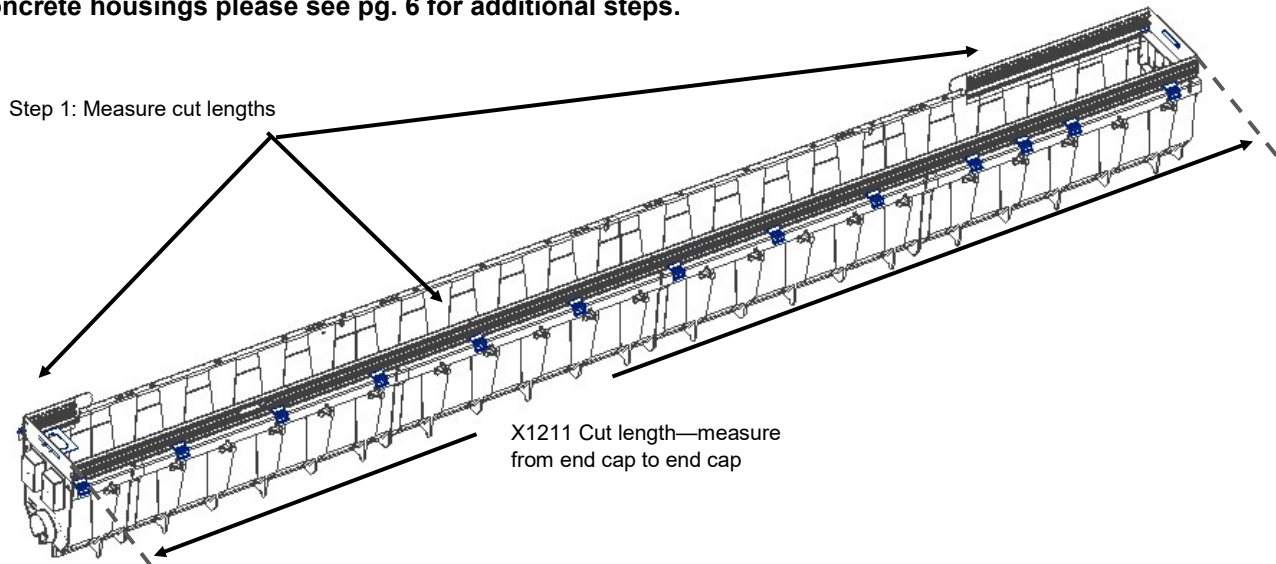

Note: Prior to the following steps, the housing must already be anchored to the pool and the encapsulations must be installed. This is critical to ensure proper fit and function of this kit!

Step 1: Measure and mark X1211 and cut to length. Repeat for Motor End and Non-Motor end pieces using X1212. See pg. 5 for diagram.

Step 2: Attach M3994 anchor clips into X1211 extrusions. Evenly space clips across all 3 pieces. Minimum 1 on each side of the housing joint, and 1-2 in the middle of the housing. The more used the better to help ensure housing keeps straight during backfill.

Note: This kit does not come with the transition pieces that fill in the gap between the encapsulation and X1211 flush lid riser extrusion. They will need to be installed at step 3. See pg. 5 for a diagram.

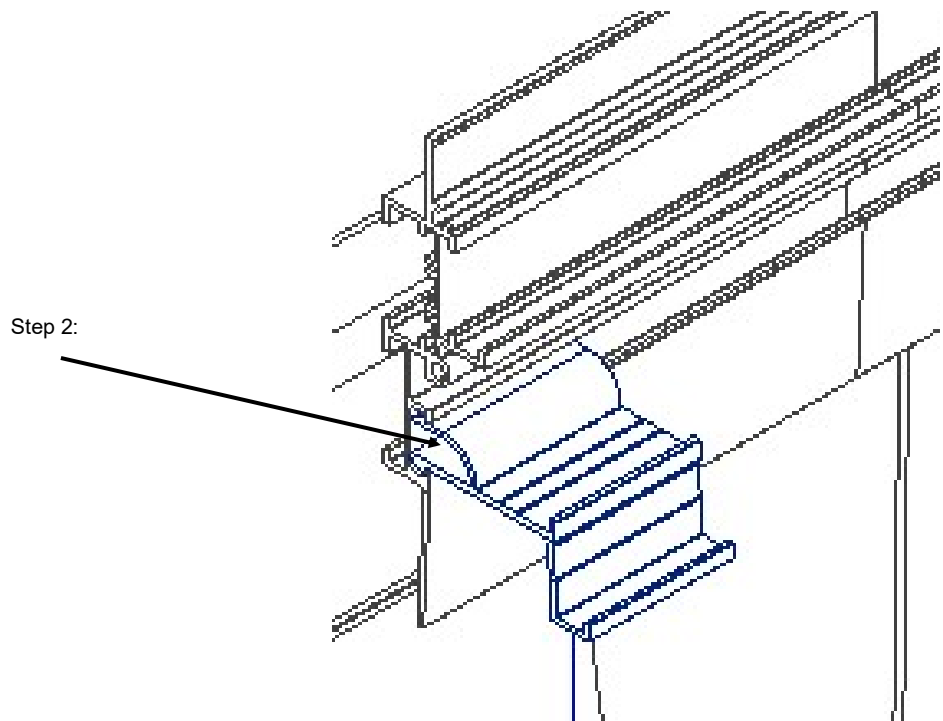

Installation Procedures

Step 2 Continued: The X1211 Riser will hold the back wall straight by providing a straight solid surface to attach the housing too. Fig. 1

- Always attach the M3994 clips on both sides of the housing joint. Fig. 1.
- Always evenly space M3994 clips across riser. Minimum two at each joint and 1-2 in middle of housing.

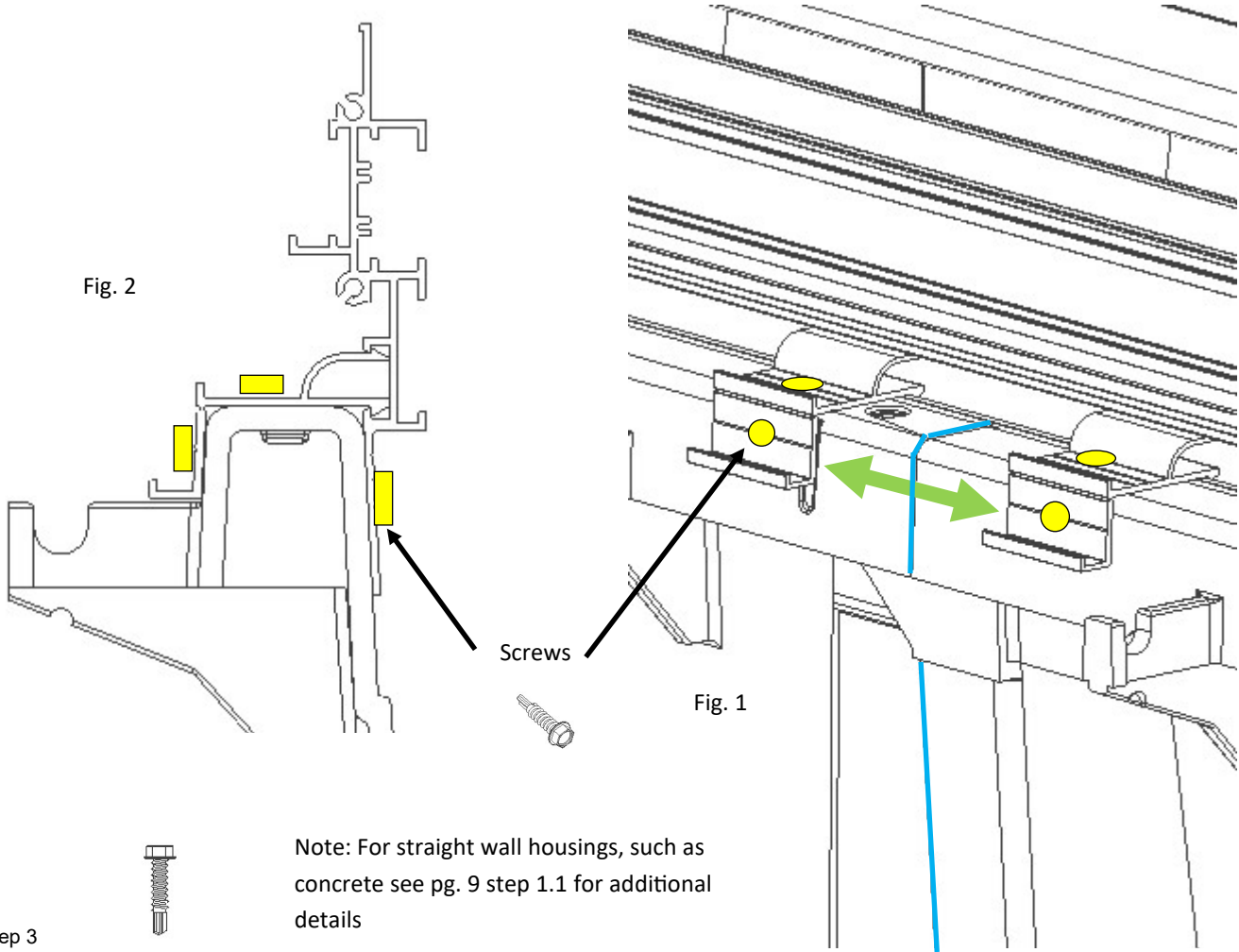

Step 3

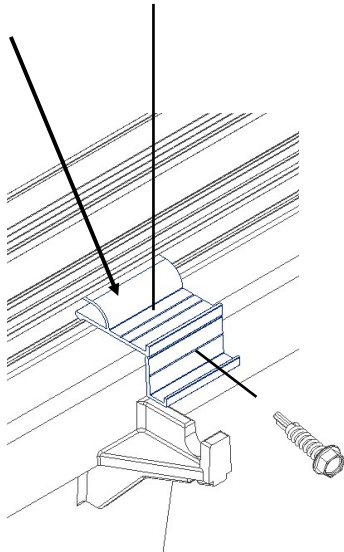

Step 3: Set the extrusions with clips on to top of housing, align and square ends. Anchor down with self drill and tap screws. Screw the clips down on outside of housing and the X1211 extrusion on the inside of housing. Anchor inside extrusion every 12-18in. or less the full length of extrusion. Minimum 2 screw per clip. Fig. 2

- Always screw into front of X1211 riser, the back and top side of riser clips. See where yellow marks are to insert screws
- Always attach X1211 riser prior to backfilling!

Note: Be careful not to over torque the screws and strip out into the plastic.

Transition Pieces will be installed at this step. These pieces come with the encapsulation kits (See pg. 5)

Notice: This step is critical to withstand back fill pressures and keep housing straight!

Installation Procedures

Step 4: Attach end plates M3997 to end of X1211 extrusions and to housing endcap by aligning holes in end plate to raceways in extrusion X1211. Use self tapping screws to anchor in place.

Step 5: Attach M2221 lid support bracket to M3997 end plate using H0152 10-32 screws and H0176 10-32 Nylock Nuts.

Step 4 & 5

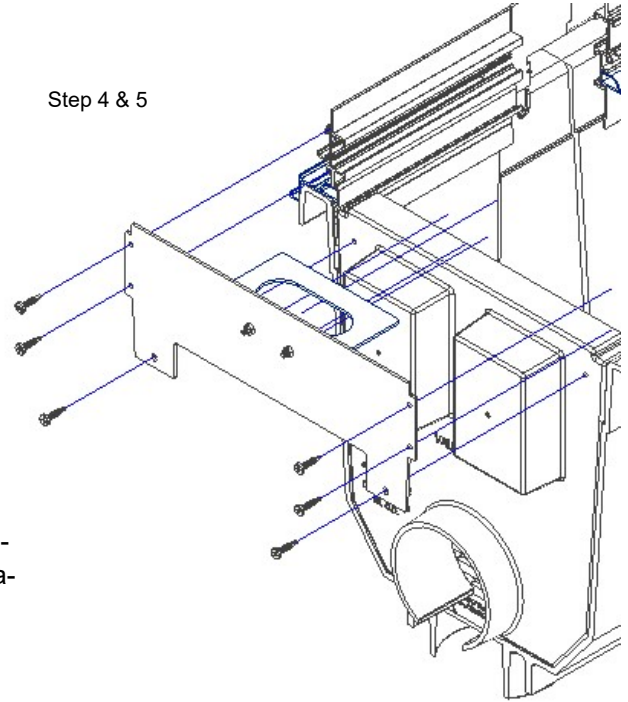

Step 6: Attach M3933 Cross Brace over the joint between housing after aluminum X1211 riser has been installed. The combination of the riser and brace help to hold everything straight.

- Always set riser over the joint of two M3995 housings.
- Always set braces prior to backfilling housing

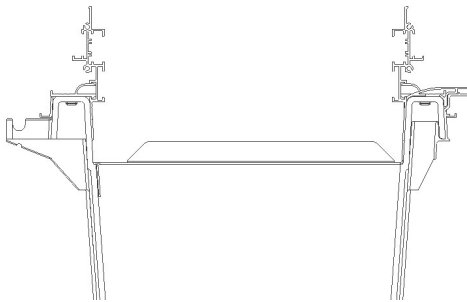

Set brace over housing joint

Step 6

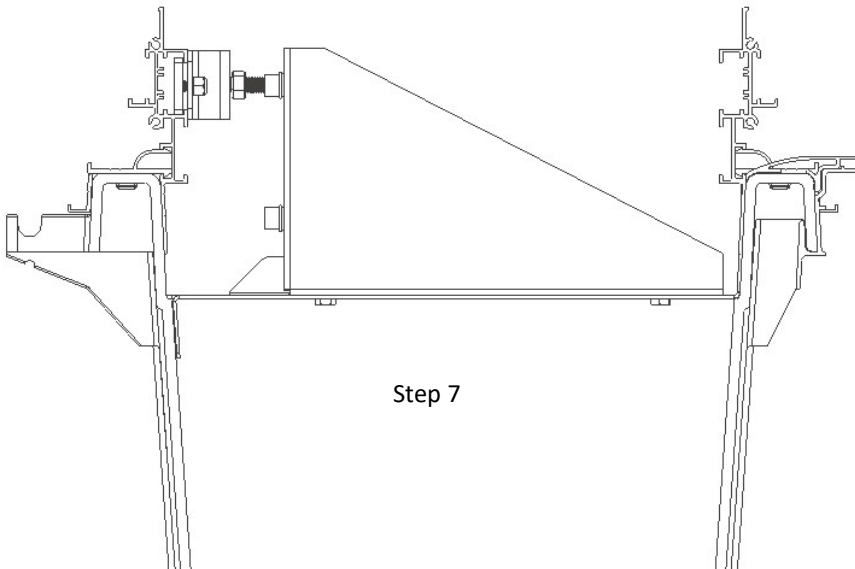
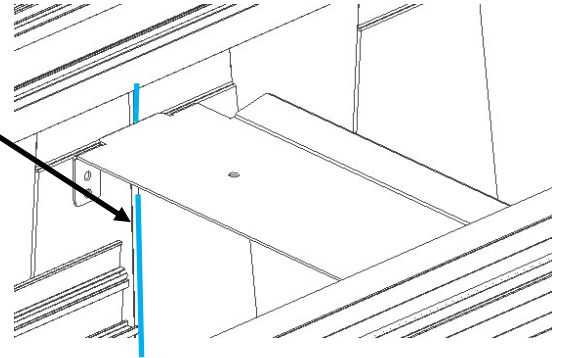

Step 7

Step 7: Attach M3997 turnbuckle brace to straighten housing. Minimum 1 brace per housing section. More may be needed to hold everything straight for backfill and concrete.

- Always use the A3987 turnbuckle brace to level and straighten the X1211 riser!

Installation Procedures

Step 8: To help maintain spacing between the X1211 riser a simple solution can be to use a wire loop strung between the two risers and twist together to pull them to the desired spacing of 13-7/8”.

1. Drill a small hole into each riser
2. String a piece of wire thru the holes creating a wire loop that have the ends twisted together
3. Using a bolt or scrap piece of rebar insert thru the loop and twist the wires together until it pulls the ends of the riser in to the desired dimension

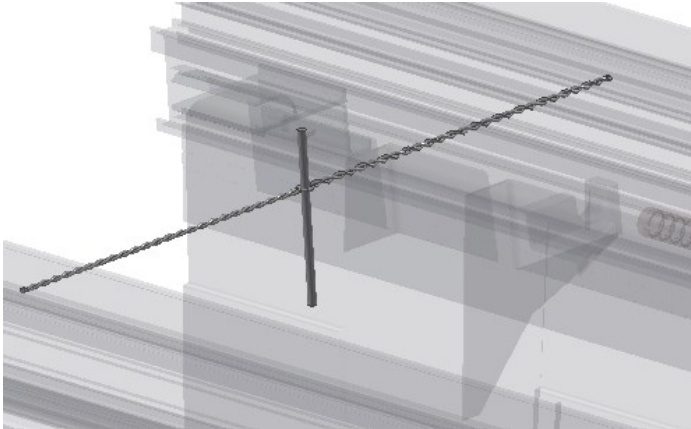

Showing wire attached and pulling riser in to desired dimension

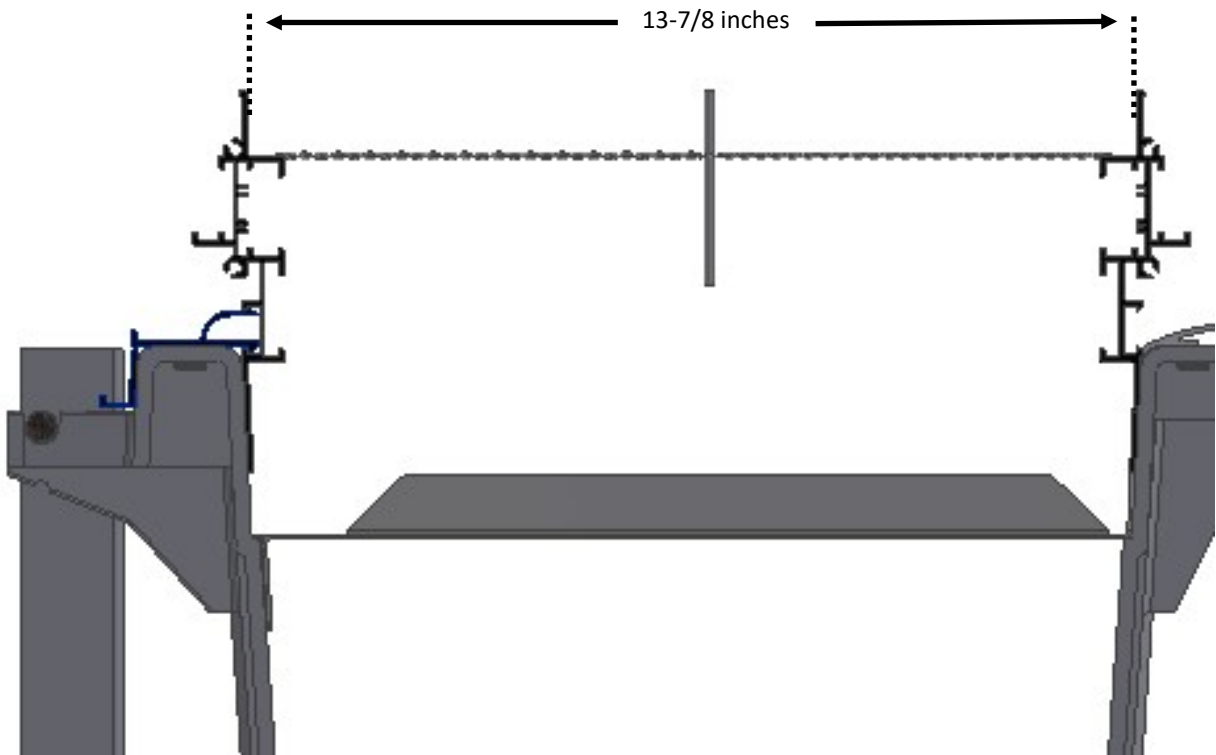

Installation Procedures

Note: Quick attach mounting brackets vary by system type. Installation procedures are the same for all types. Part numbers shown may vary.

Step 9: Layout the 4 different quick attach mounting bracket parts around the housing as shown. Each bracket has a mating anchor plate and two 1/4-20 nylock nuts. See Diagram 1.

Final plate location will be adjusted during the system installation.

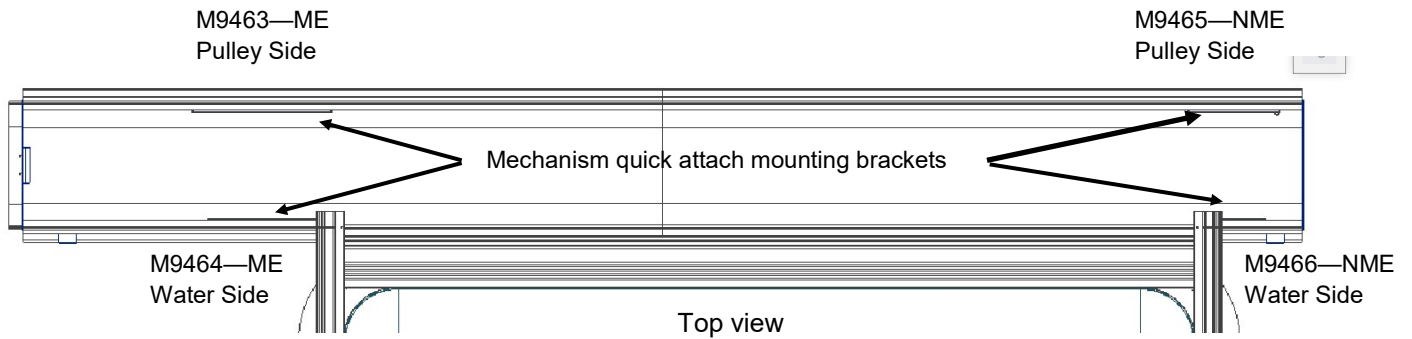
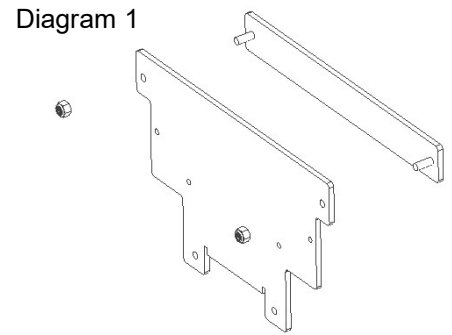

Step 10: Insert the anchor plate into the X0211 top channel by inserting the top in first, lifting up then pushing in the bottom. The part then sets into the lower channel. See diagram 2.

With the anchor plate in place attach the quick attach plate to the mating bolts protruding from the anchor plate. Attach the nylock nuts and tighten down.

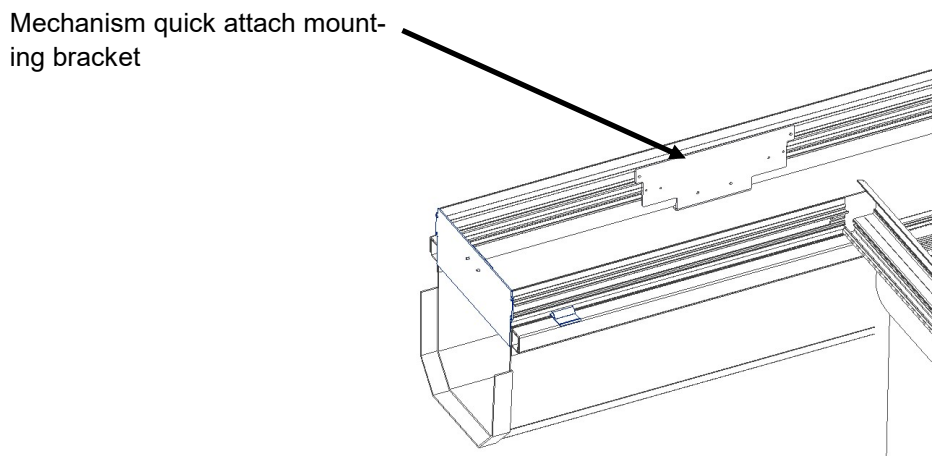
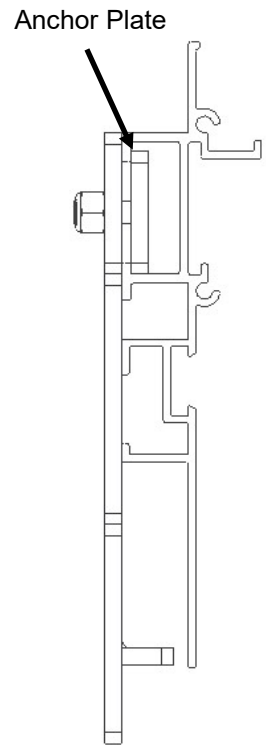

Diagram 2

Installation Procedures

Note: Not all kits come with the lid. These steps will need to be followed once the lid arrives to the job site.

Step 11: Assemble the lid X0008 & X0009 and attach the lid end protectors to the cut ends of the lid M8096 & M8097. Note the orientation of the lids. Correct orientation is critical to allow the end caps to fit into place.

Step 12: Insert your lid into the housing and check fit of the part. Make any necessary adjustments if there are any fit issues prior to back fill and decking being poured.

Step 9

Step 8

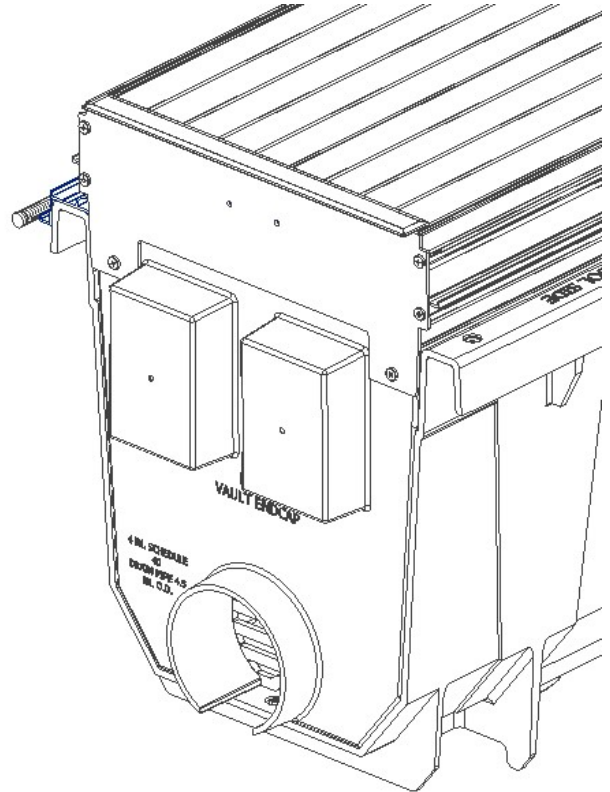
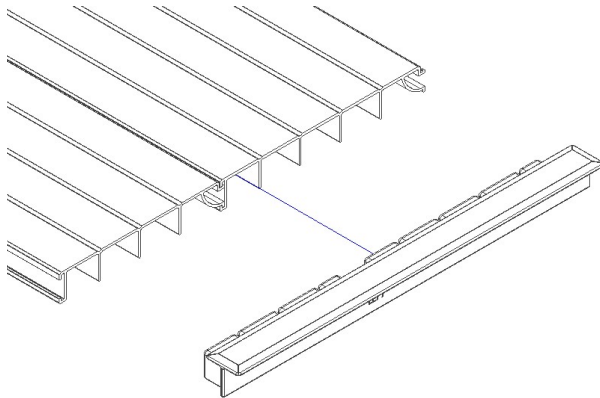

Note: This kit does not come with the transition pieces that fill in the gap between the encapsulation and X0211 flush lid riser extrusion. They will need to be installed at step 3.

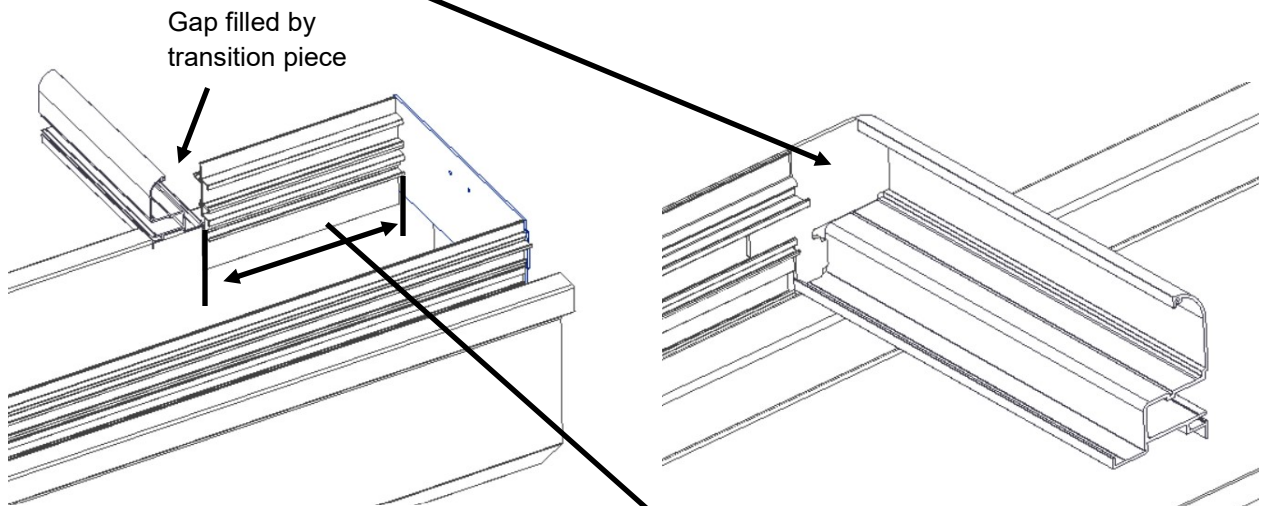

Cut length for ME & NME X0212 extrusion pieces go from housing end plate to back end of encapsulation.

Installation Procedures

Note: For housings with straight walls such as a concrete housing follow these instructions along with the remainder of the steps on these instructions

Step 1.1: Snap on clip part M3917 to bottom of X1211 riser. This clip adjusts the 3Deg angle on X1211 to make a straight 90deg surface to mount to the pool walls.

Attach every 18" or less full length of X1211 extrusions.

One M3917 clip will need to be placed under each lid bracket for support.

The part can now be attached to the housing wall following step 2-9.

