

Aluminum Bench Installation Instructions

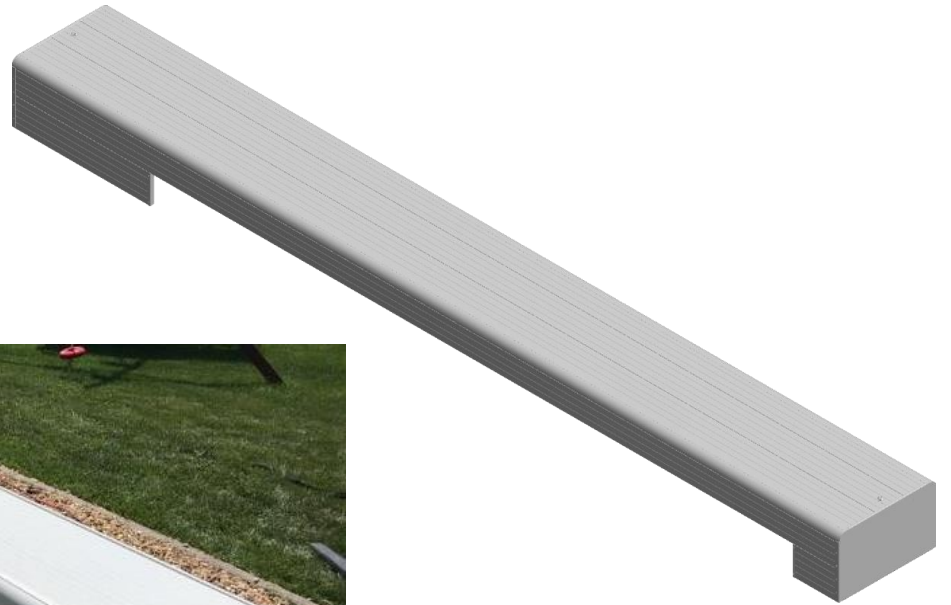

Required Tool & Parts List

- Skill Saw - for cutting aluminum extrusion
- Drill
- Impact Drill
- Hammer Drill (with bit for anchoring brackets into deck)
- Square
- Tape Measure
- 5/16" Hex Drill Driver
- #2 Phillips Drill Bit
- 7/8" Drill Bit - for drilling out hole for lid lock
- 1/8" Drill Bit
- 9/16" Wrench
- 9/16" Socket
- Pencil or Marker
- 3/8" Concrete Anchor Bolts

Bench Dimensions

TOP

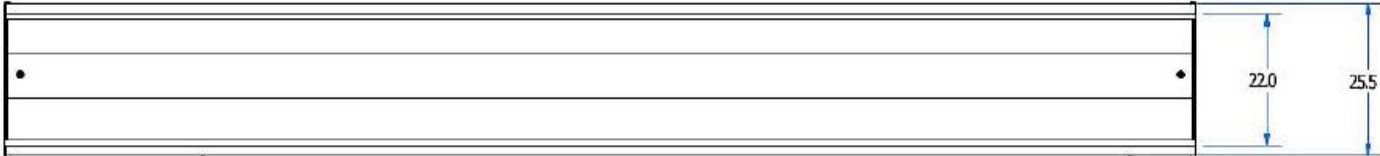

FRONT

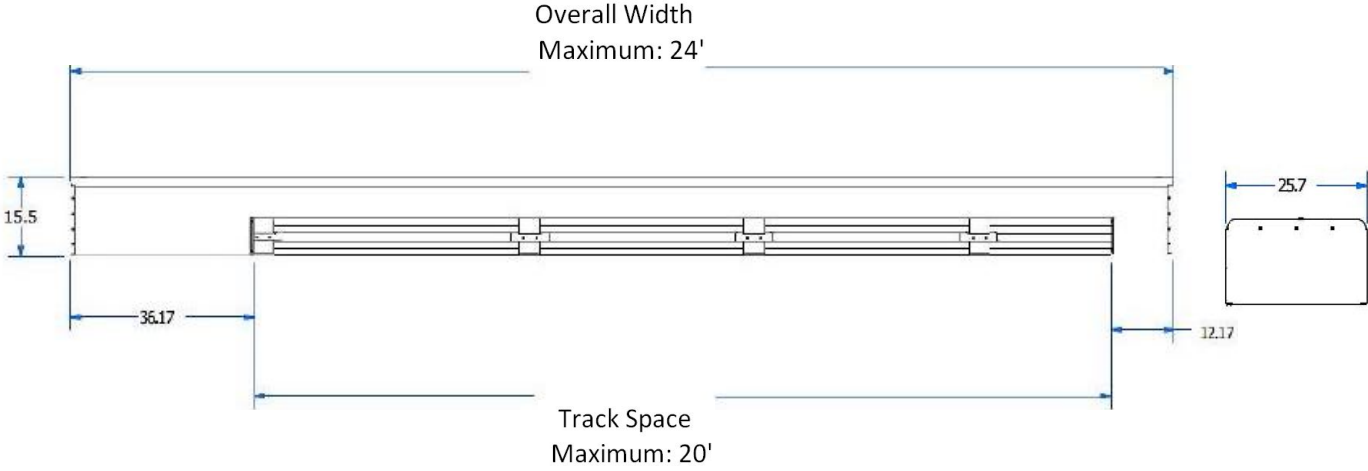

**ALUMINUM BENCH
HARDWARE INSTALL KIT A3380**



H1122
QTY: 2



33237
QTY: 8



H0700
QTY: 26



33278
QTY: 6



M1033
QTY: 2



H0203
QTY: 8

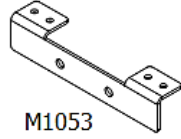

M1053
QTY: 8



M1054
QTY: 2



H0313
QTY: 35

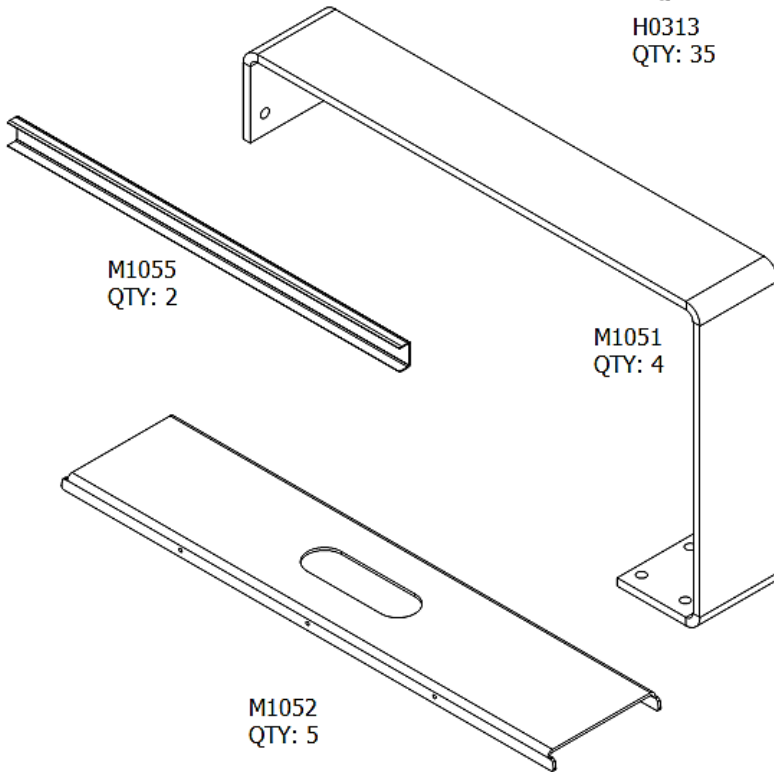

M1055
QTY: 2

M1051
QTY: 4

M1052
QTY: 5

X0008
QTY: 3

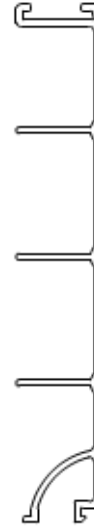

X0009
QTY: 3



56022
QTY: 4

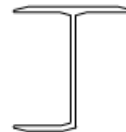

X0857
QTY: 2

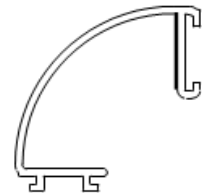

M9091
QTY: 1

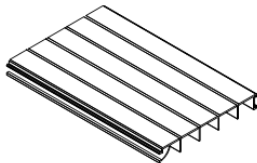

M9090
QTY: 1



M1050
QTY: 2

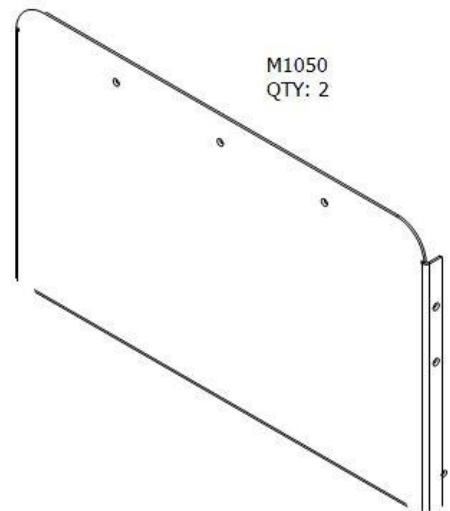

Exploded View & Parts Detail List

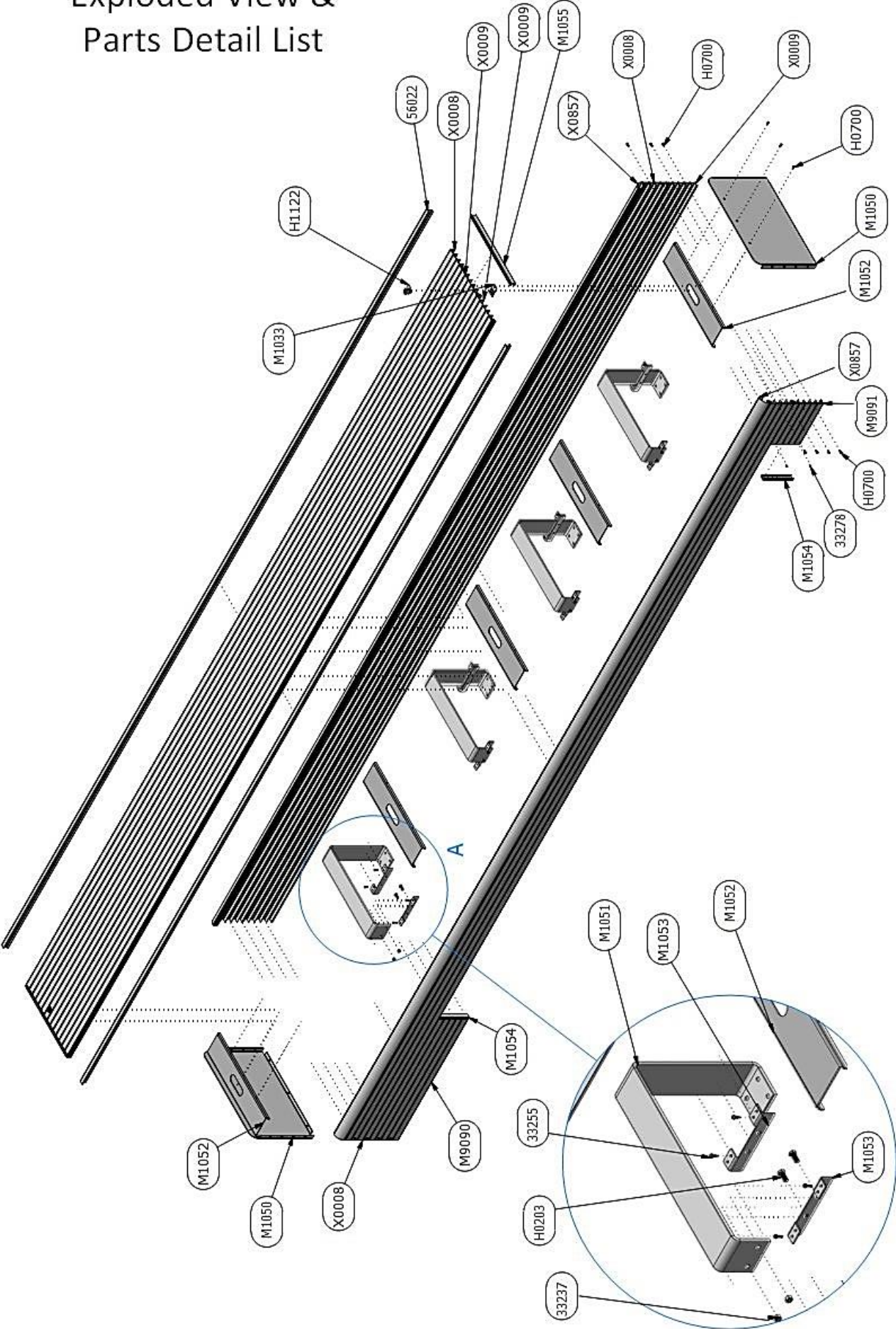

1 - Measure

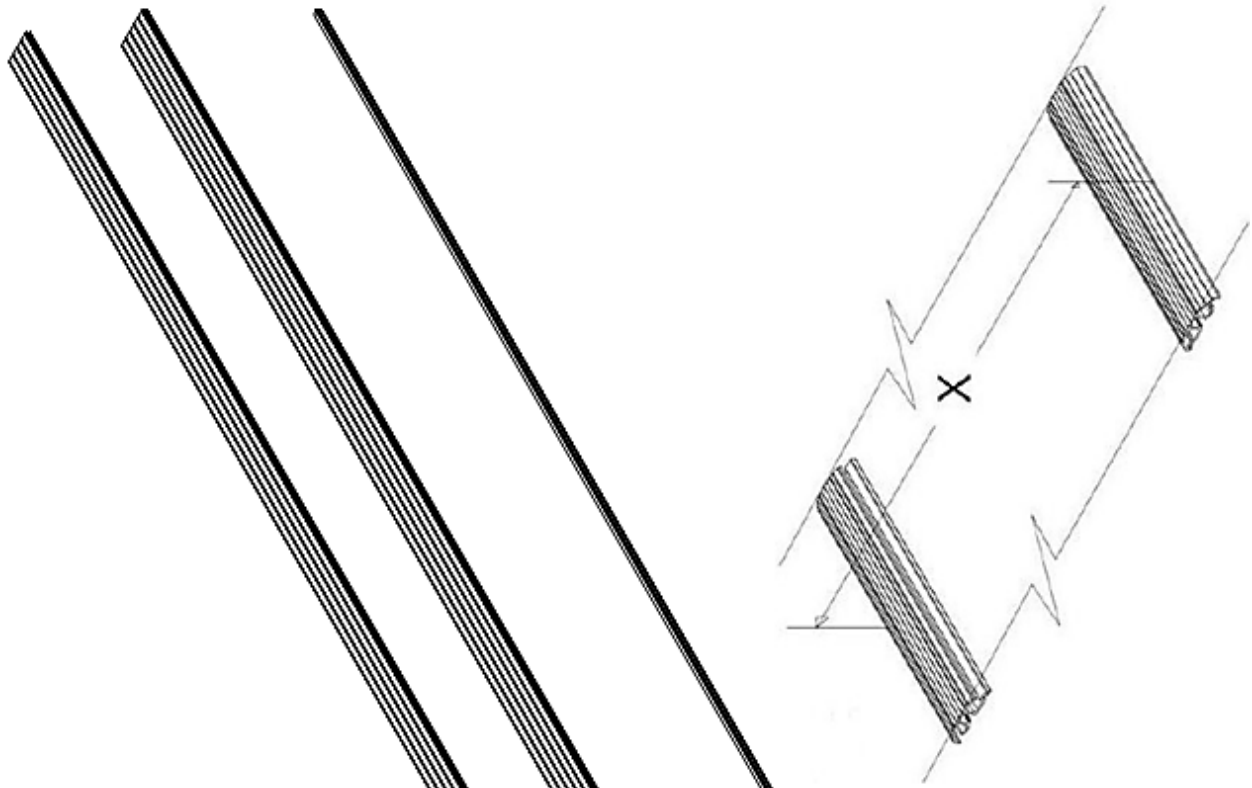

2 - Cut

X0008 - 6" LID
2 @ (X + 48.25") - RISER
1 @ (X + 48") - LID

X0009 - 7.5" LID
1 @ (X + 48.25) RISER
2 @ (X + 48) LID

**X0857 - ROUNDED
CORNER EXTRUSION**
2 @ (X + 48.25)

3 - Lid Assembly

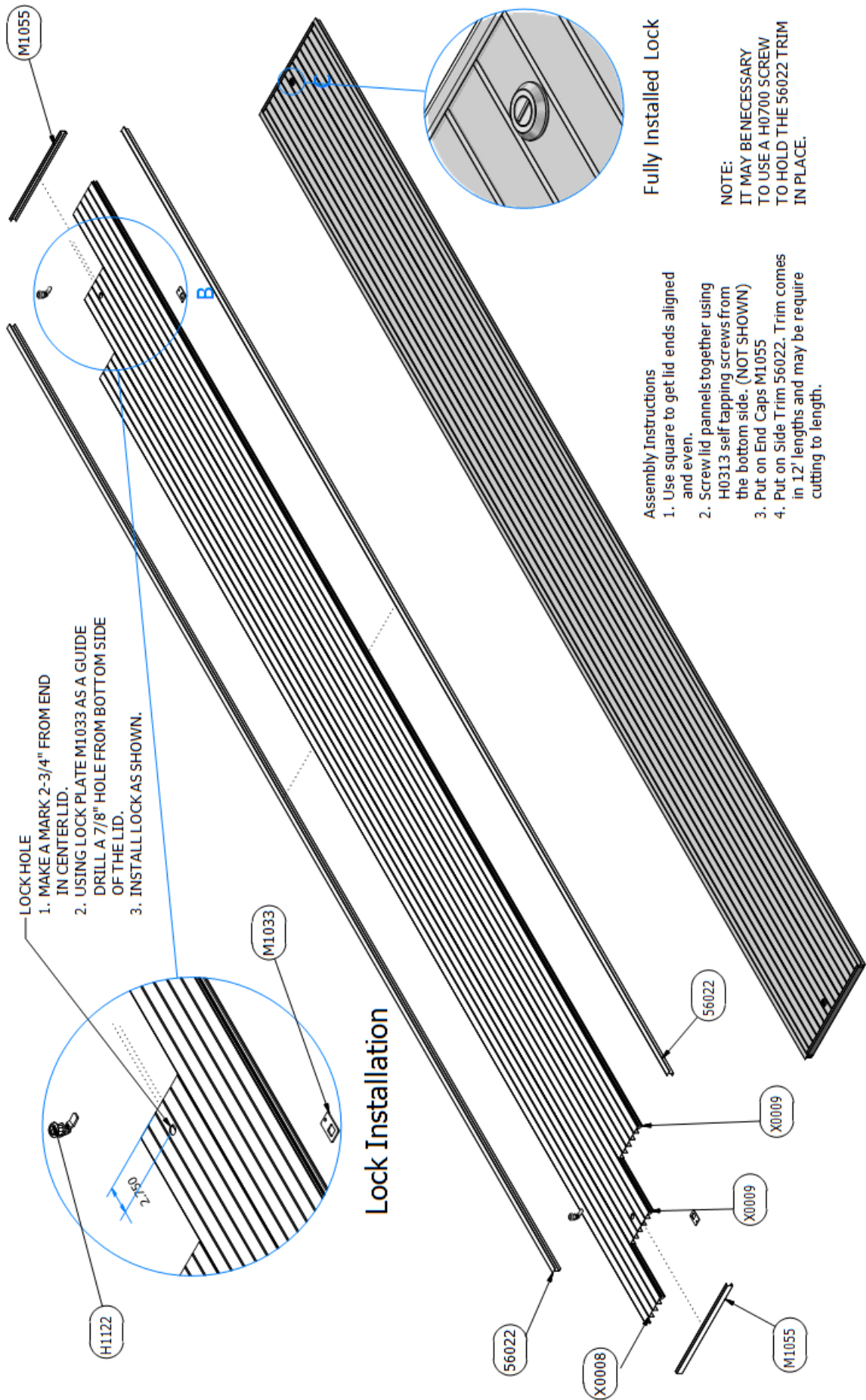

4 - Front & Back Riser Assembly

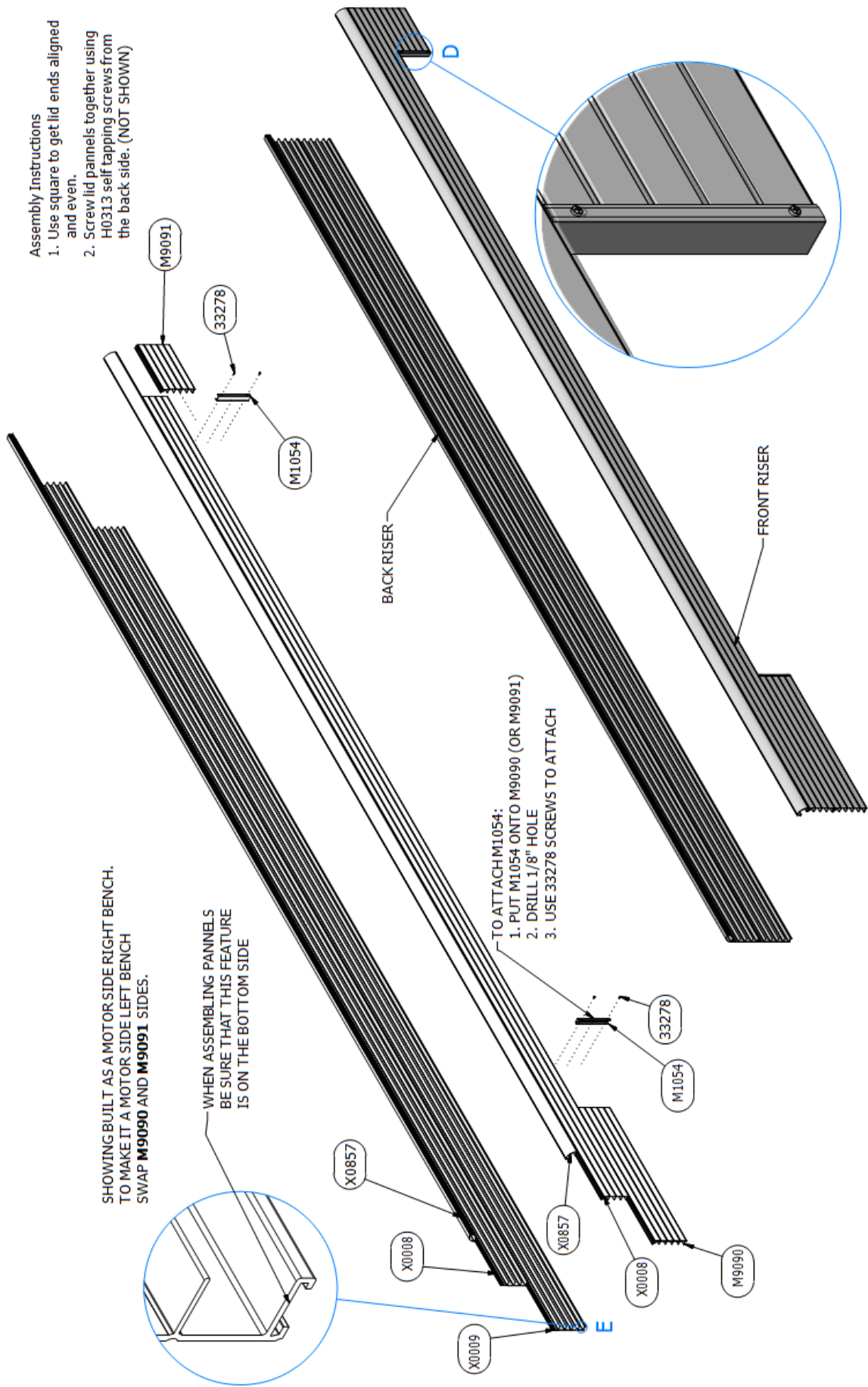

5 – Support Bracket

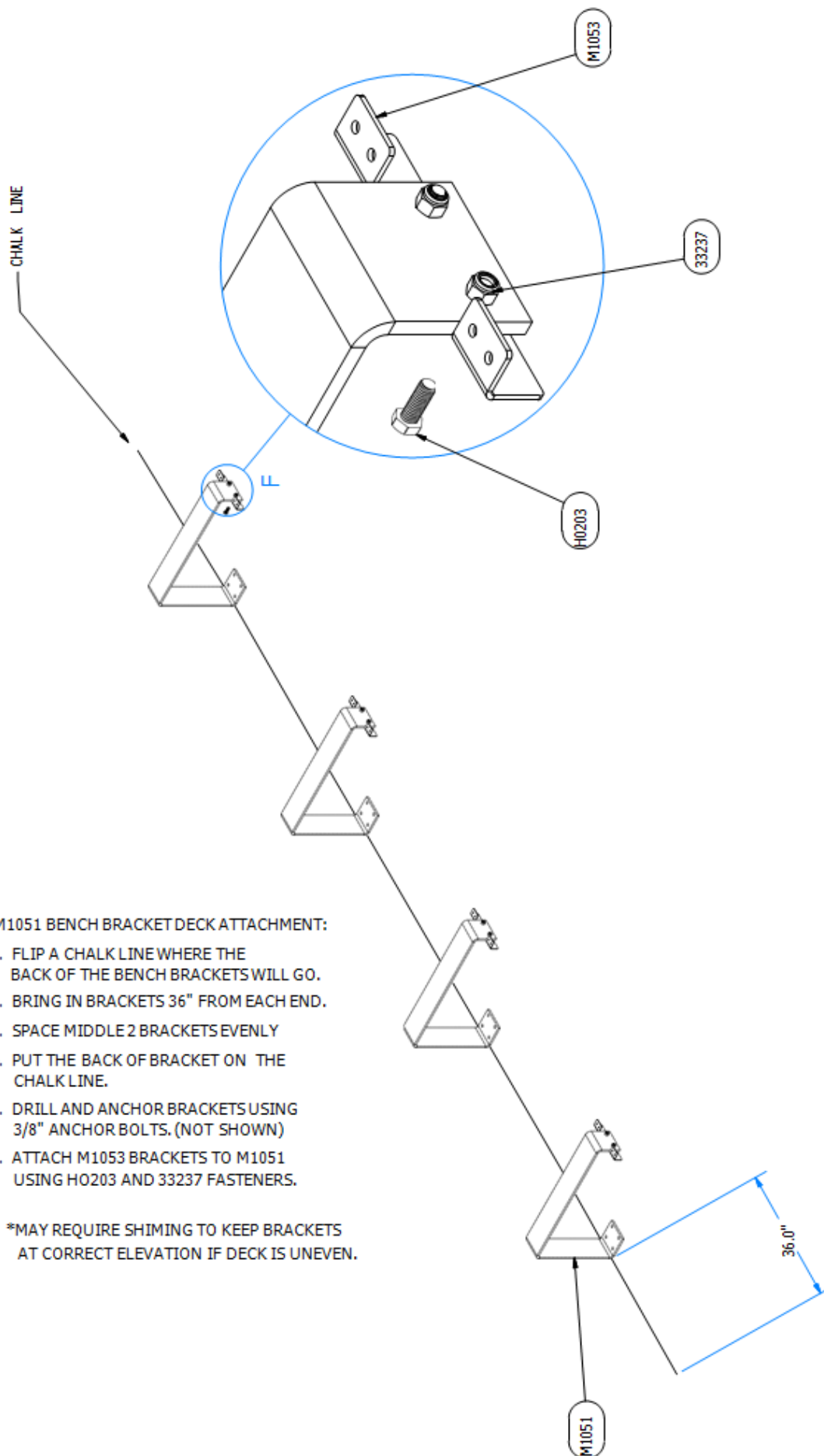

6 - End Plate & Lid Plate

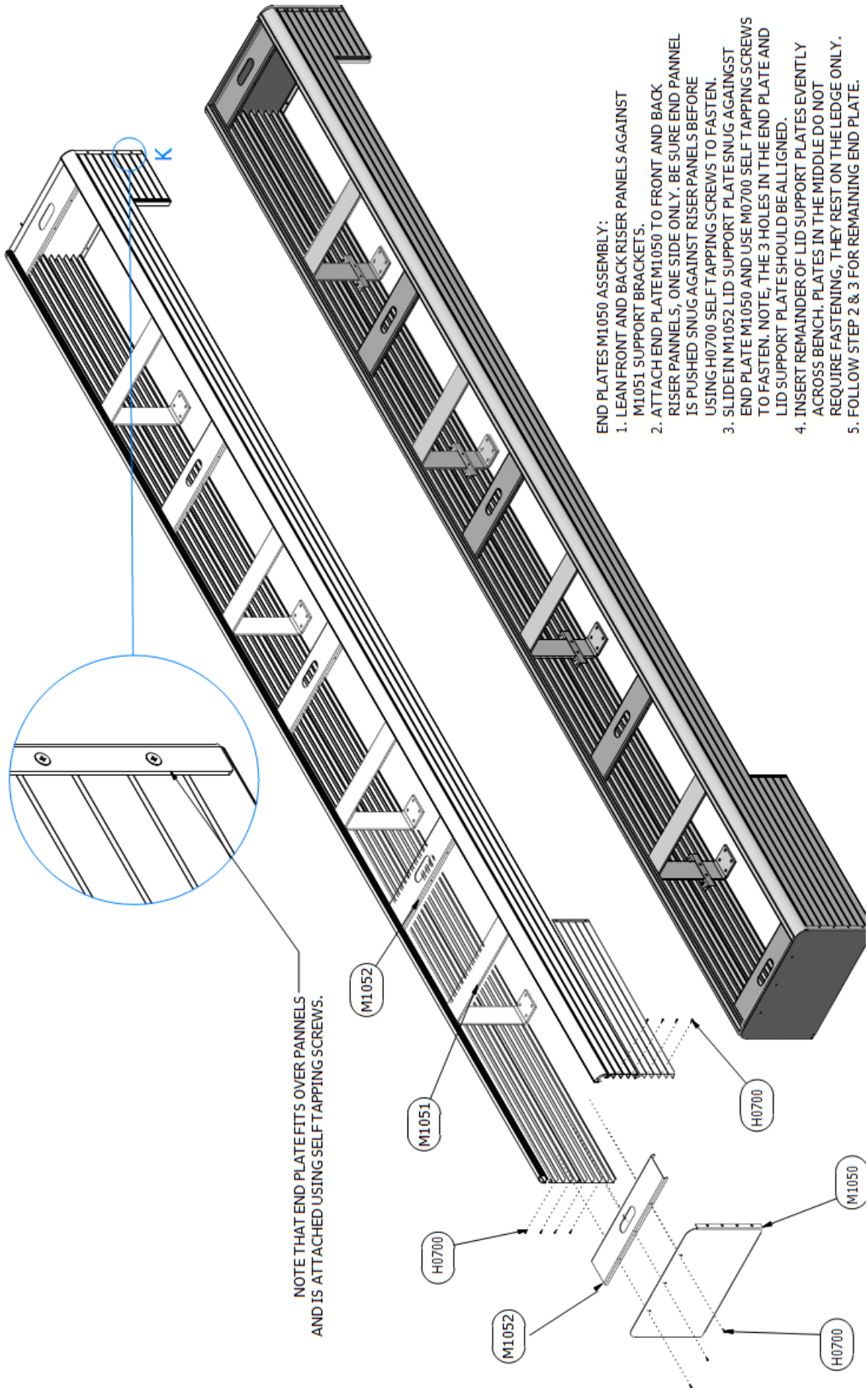

7 - M1053 Attachment Bracket

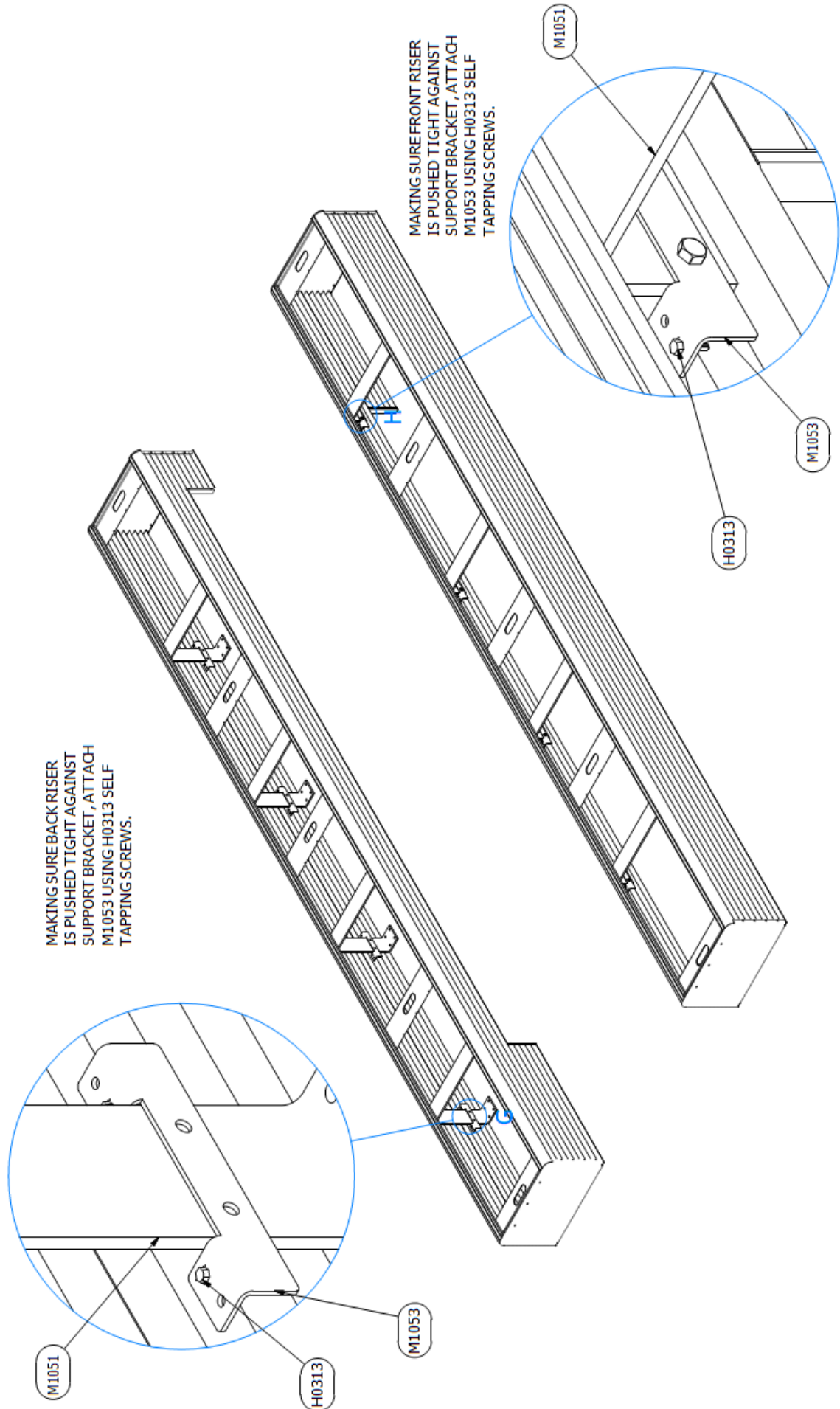

8 - Lid Attachment

1. Drop lid into place.
2. Turn locks to lock lid into place.
3. Check plastic lid trim to make sure it is seated properly. Round off any sharp corners.

* It may be necessary to use a self tapping screw H0700 to hold the Lid Trim 56022 in place.

